

Vision for Growth Committee Meeting #2



Spring Hill USD 230

March 30, 2016

Agenda

- Welcome
- Review of previous meeting
- Discuss homework assignment
- RSP presentation on District demographics
- Turning Point Q/A
- Review Guiding Principles
- Master Plan Update
- Housekeeping
 - Homework
 - Review Schedule
 - A peek into next week



5 Simple Rules

- Have fun!
- Keep meetings to 1-½ hours (ideally 1 hour).
- Be objective and open-minded.
- Listen, share and contribute.
- Remember, ... it is all about the kids!



Previous Meeting Highlights

- Explained why you are here
- Discussed prior Community Group's "Guiding Principles"
- Discussed your perception of the District
- Issued Homework assignments

Planning for Success

USD 230 Guiding Principles for 2016:

1. Technology Rich Classrooms and Schools
2. Safe & Secure Schools
3. 21st Century Schools for Students & Teachers
4. Facilities that Maintain Low Student / Teacher Ratios
5. Educational Parity & Equity
6. Improve Early Childhood Opportunities
7. Health & Wellness Opportunities
8. Discussion: Timeline for future bond referendums?

Homework Report

- Ask your neighbor / co-worker how they feel about the District's performance and its current facilities.
- Additionally, ask them if they think Spring Hill is growing.

RSP Demographics Report

How did KU's loss affect your Easter weekend?

1. Ruined it
2. Not a big deal
3. I expected it
4. They played?
5. What does KU stand for?

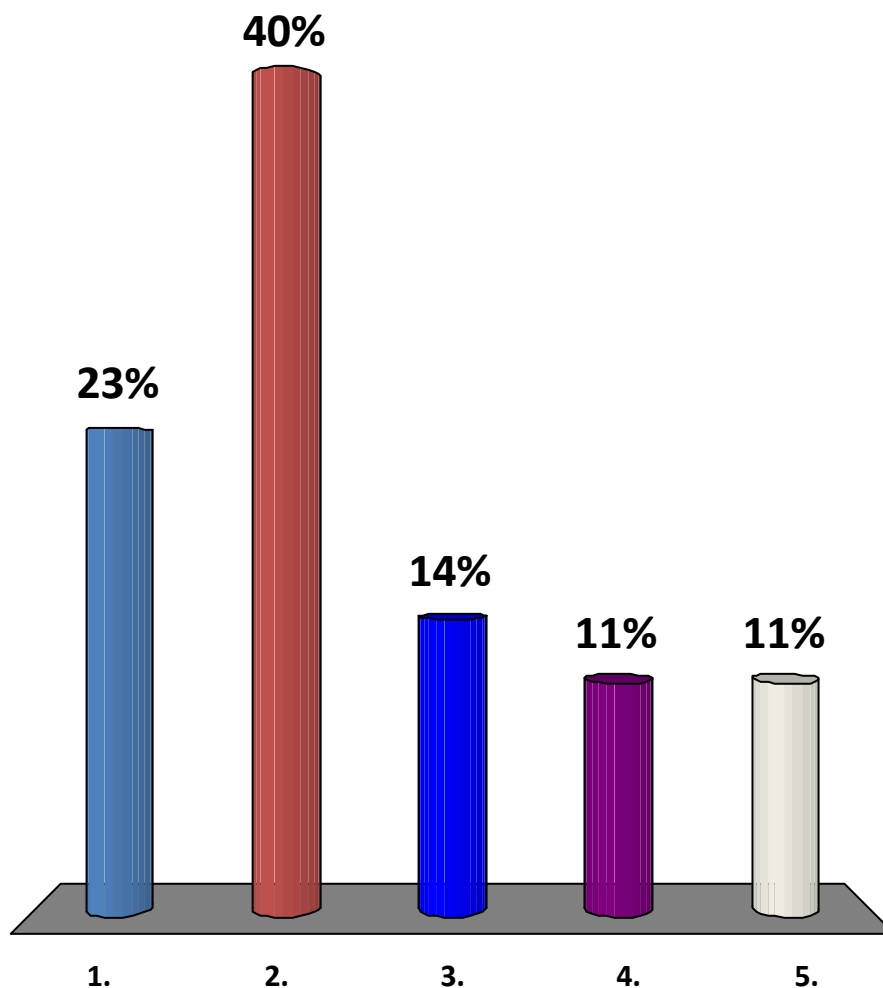

Do you think your neighbors will believe the projected student enrollments?

1. Yes
2. No
3. Not sure

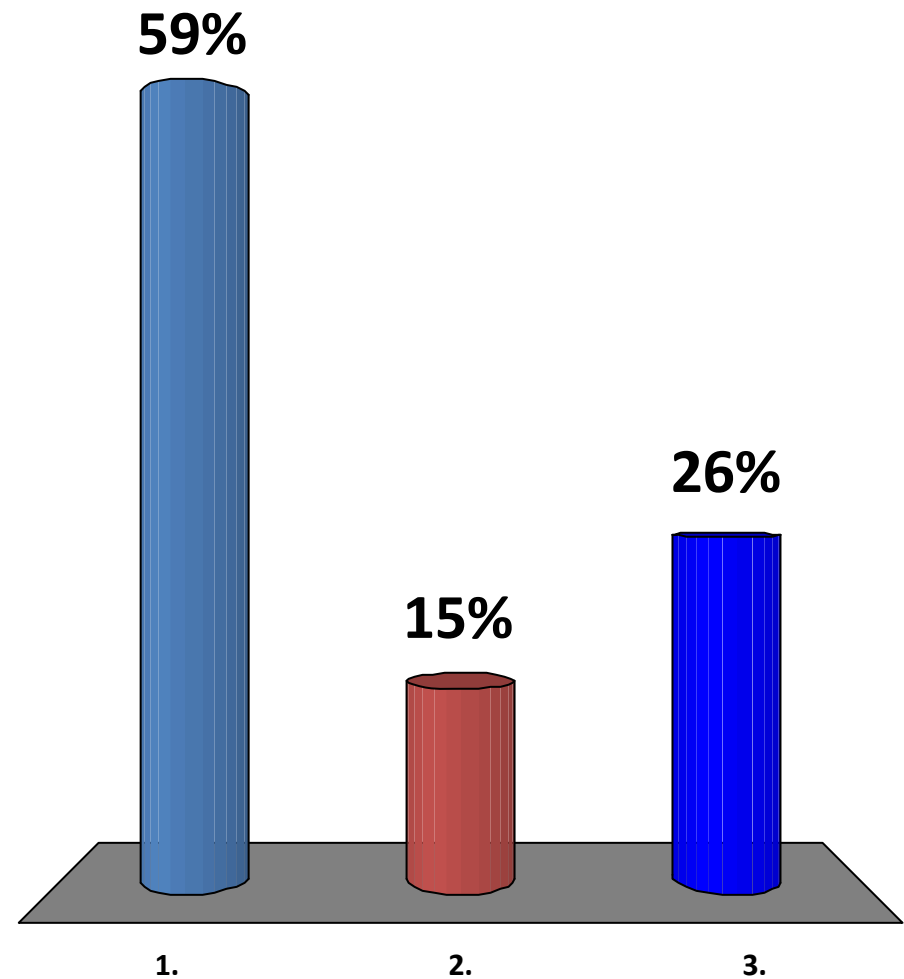

Based on the growth data presented, what is your level of concern regarding the district having adequate space for students in 3 years without improvements?

1. High concern
2. Medium concern
3. Low concern
4. No concern

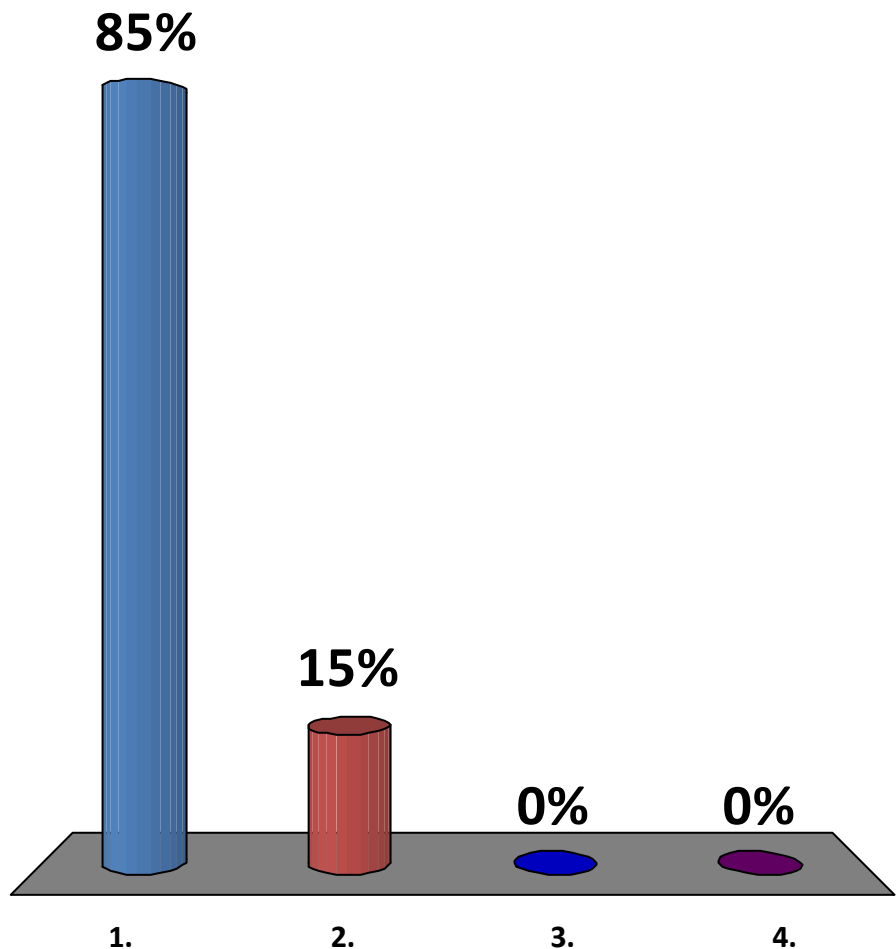

Based on the growth data presented, where do you think the public will perceive the biggest needs are in the district?

1. North part of district
2. Western part of district
3. In town
4. All over district
5. They won't see a need.

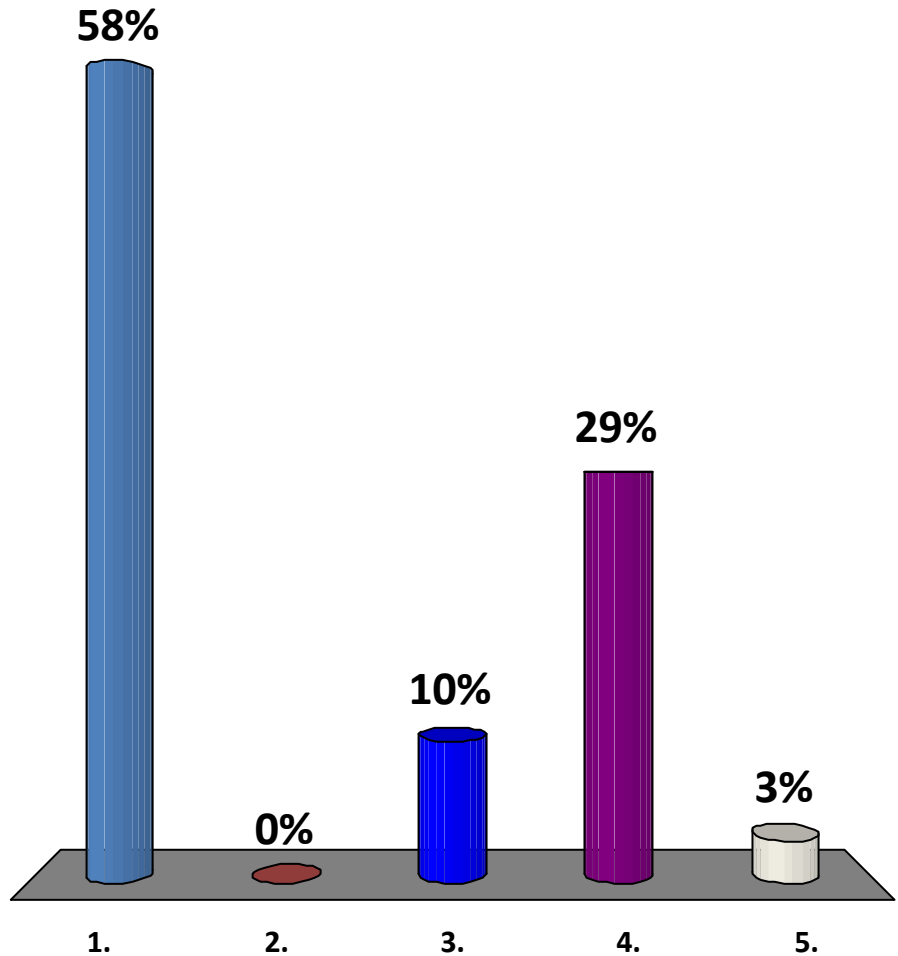

District Master Facility Plan

Planning for Success

2003 Spring Hill USD Master Plan

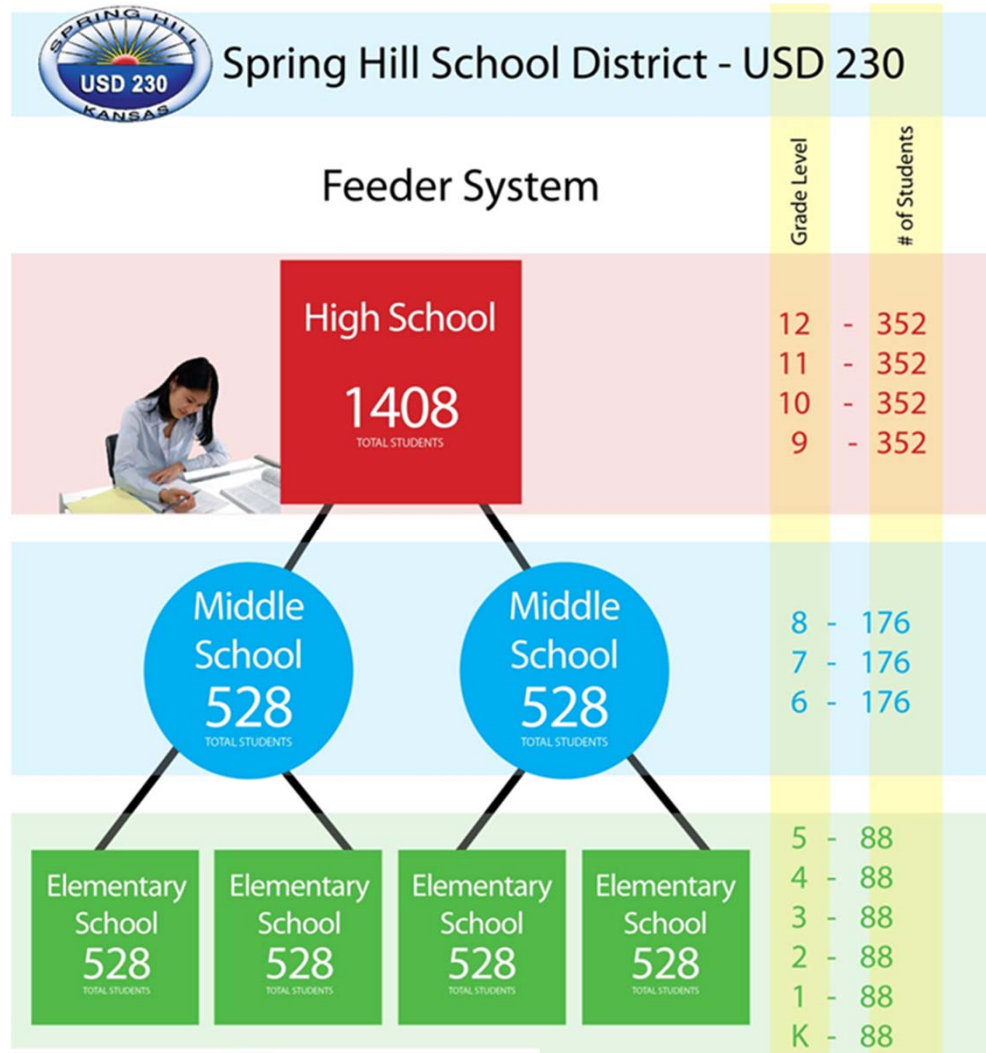

A Community Driven Master Plan

- Parents, patrons, teachers and district staff spent months preparing the District Master Plan.
- Key Master Plan drivers:
 - Address growth in student enrollment
 - Address District educational technology needs
 - Address District maintenance needs

Phase 1 Implementation Plan

2003 Bond Issue

- Community Group recommended a conservative approach in addressing District growth needs (phased construction).
- The Board of Education authorized a \$48,600,000 bond referendum (mail-in ballot) to be run December 9, 2003.

Phase 1 Implementation Plan

2003 Bond Issue

Scope of Work & Budget

– Construct Ph. 1 of new Spring Hill HS:	\$35,191,090
– Move Spring Hill MS into Spring Hill HS:	\$ 339,909
– Convert Spring Hill MS into an ES:	\$ 1,619,000
– Construct Ph. 1 of Prairie Creek ES:	\$ 8,450,000
– Address Near Term Technology Needs:	\$ 1,000,000
– USD 230 Contingency:	\$ 2,000,000
	\$48,600,000

Spring Hill HS – Site Plan

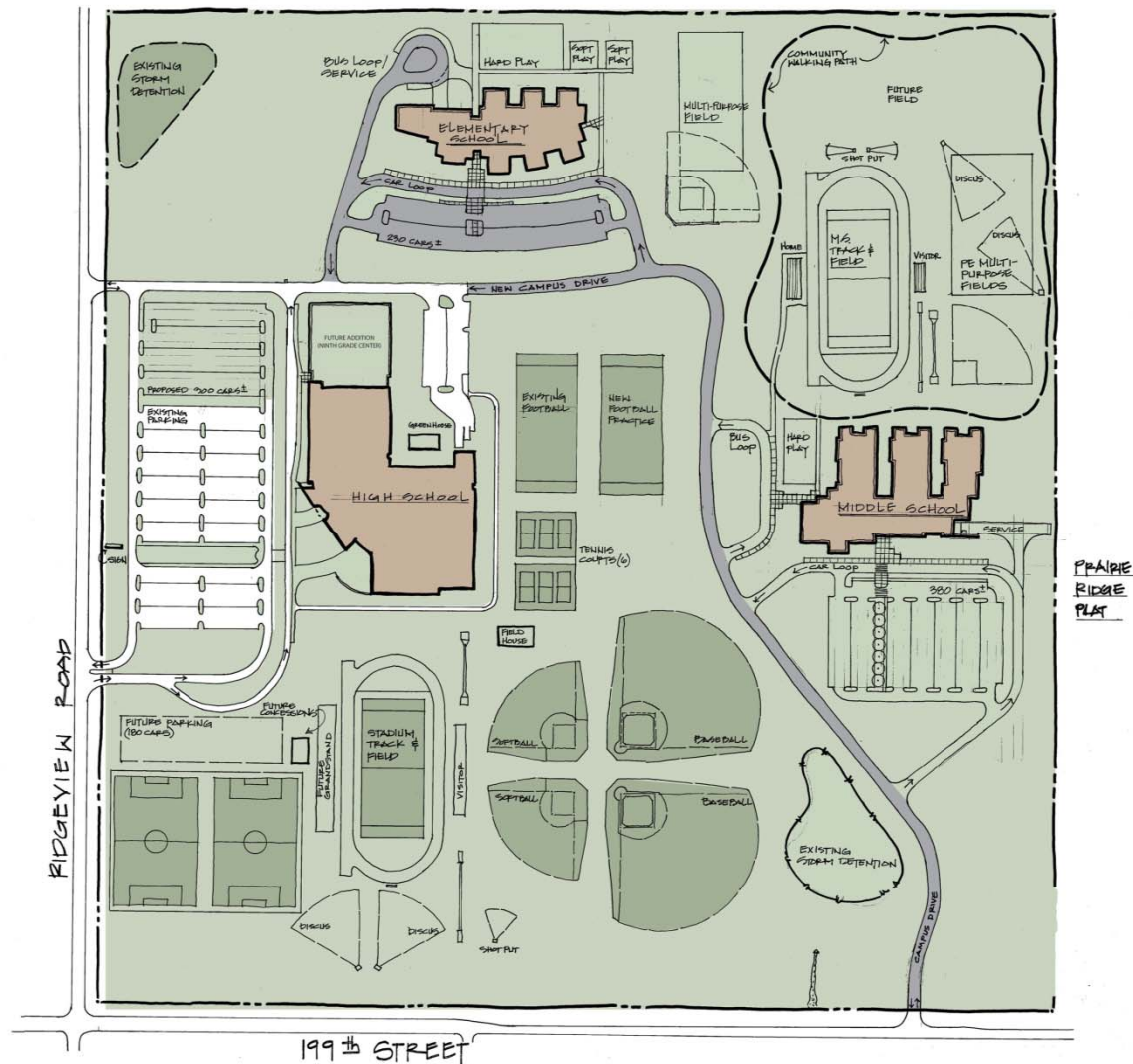

Prairie Creek ES – Floor Plan

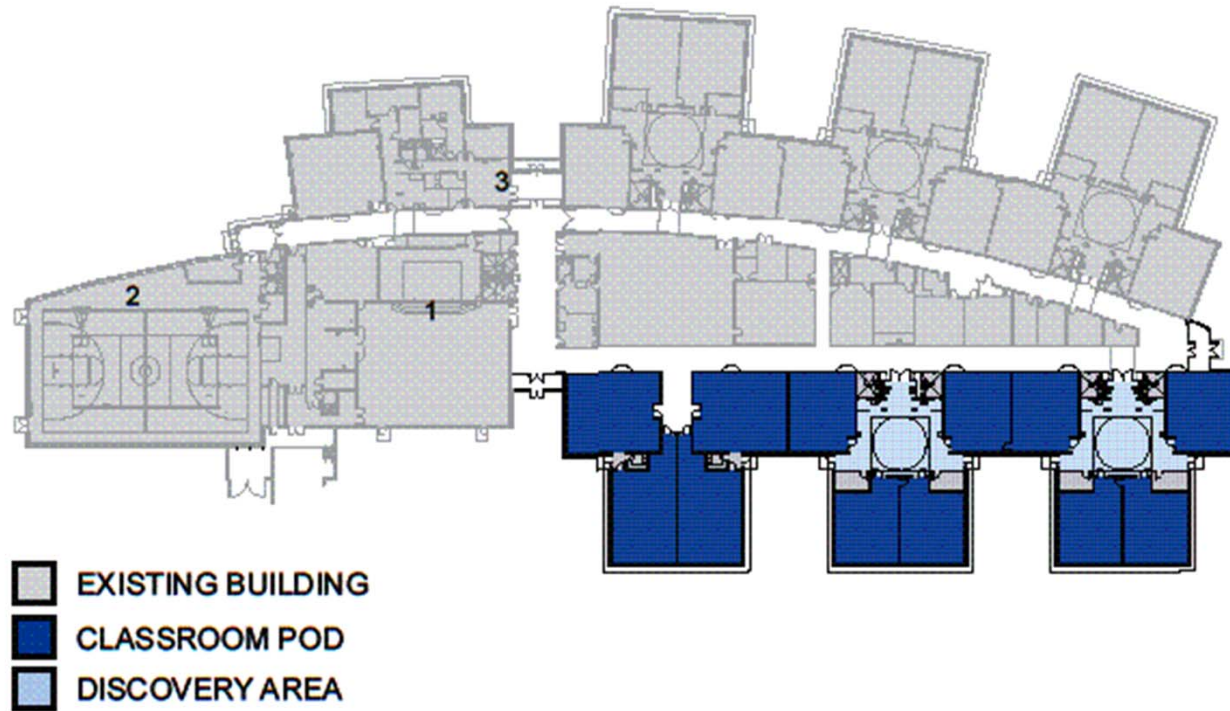

ADDITIONAL BOND IMPROVEMENTS:

1. WIDEN PROSCENIUM OPENING AT STAGE
2. ADD BLEACHERS AT GYM
3. IMPROVE VISUAL SECURITY AT MAIN ENTRANCE
4. ADDITIONAL PARKING AT MAIN PARKING LOT

Prairie Creek ES - Exterior



Phase 2 Implementation Plan

2011 Bond Issue

- Community Group recommended a conservative approach in addressing District growth needs (phased construction) and near term maintenance and technology needs.
- The Board of Education authorized a \$39,000,000 bond referendum (mail-in ballot) to be run June 7, 2011.

Phase 2 Implementation Plan

2011 Bond Issue

Scope of Work & Budget

– Expand Prairie Creek ES:	\$ 5,250,000
– Construct new Wolf Creek ES:	\$21,000,000
– Address All Deferred Maintenance Needs:	\$ 4,000,000
– Address Near Term Maintenance Needs:	\$ 1,500,000
– Address Near Term Technology Needs:	\$ 2,250,000
– Energy Efficient HVAC at SHES & SHMS	\$ 3,500,000
– USD 230 Contingency:	\$ 1,500,000
	\$39,000,000

Prairie Creek ES – Floor Plan

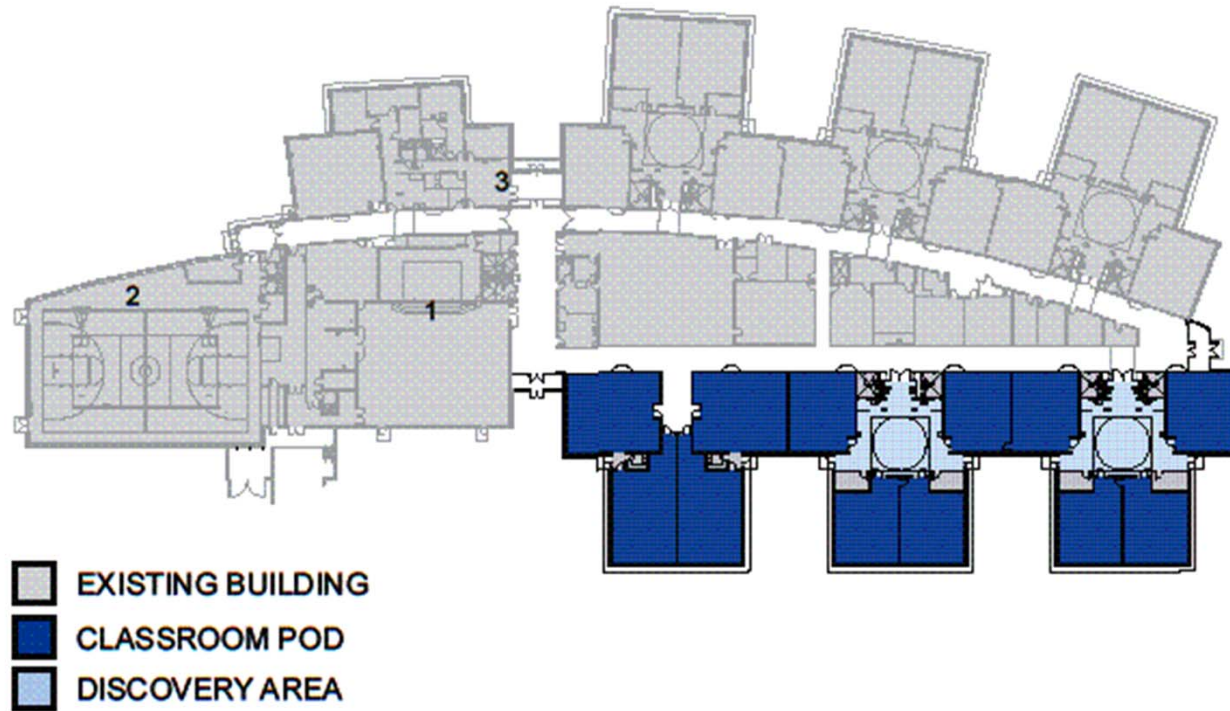

ADDITIONAL BOND IMPROVEMENTS:

1. WIDEN PROSCENIUM OPENING AT STAGE
2. ADD BLEACHERS AT GYM
3. IMPROVE VISUAL SECURITY AT MAIN ENTRANCE
4. ADDITIONAL PARKING AT MAIN PARKING LOT

Prairie Creek ES - Exterior



Wolf Creek ES – Floor Plan

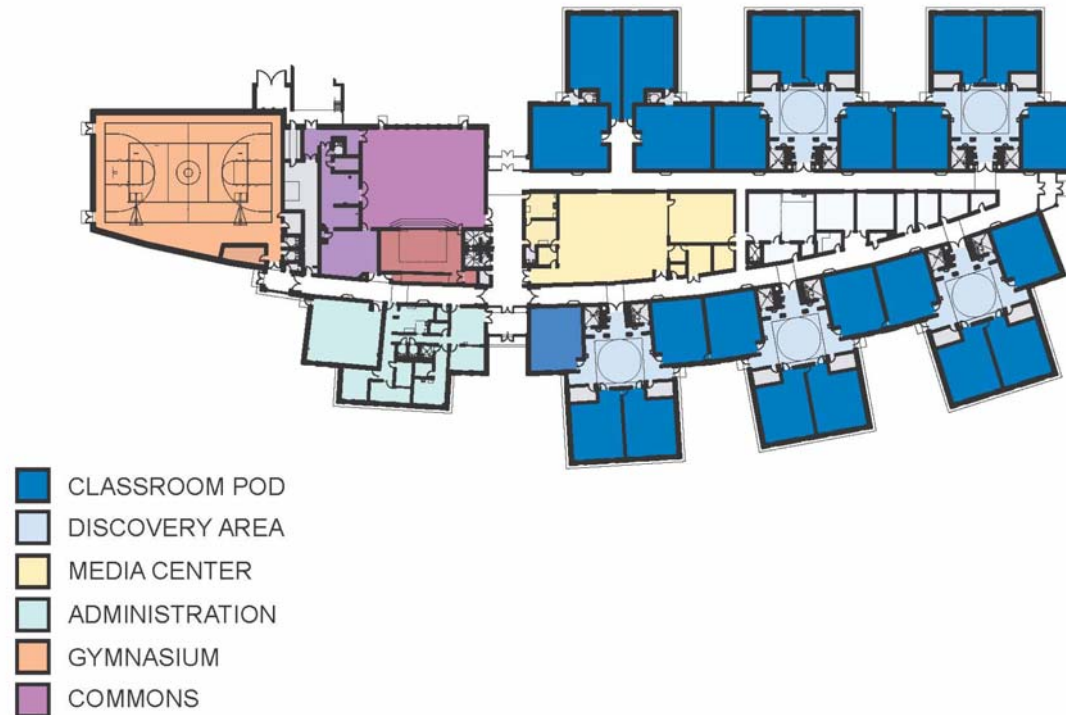

Coffee Creek Development

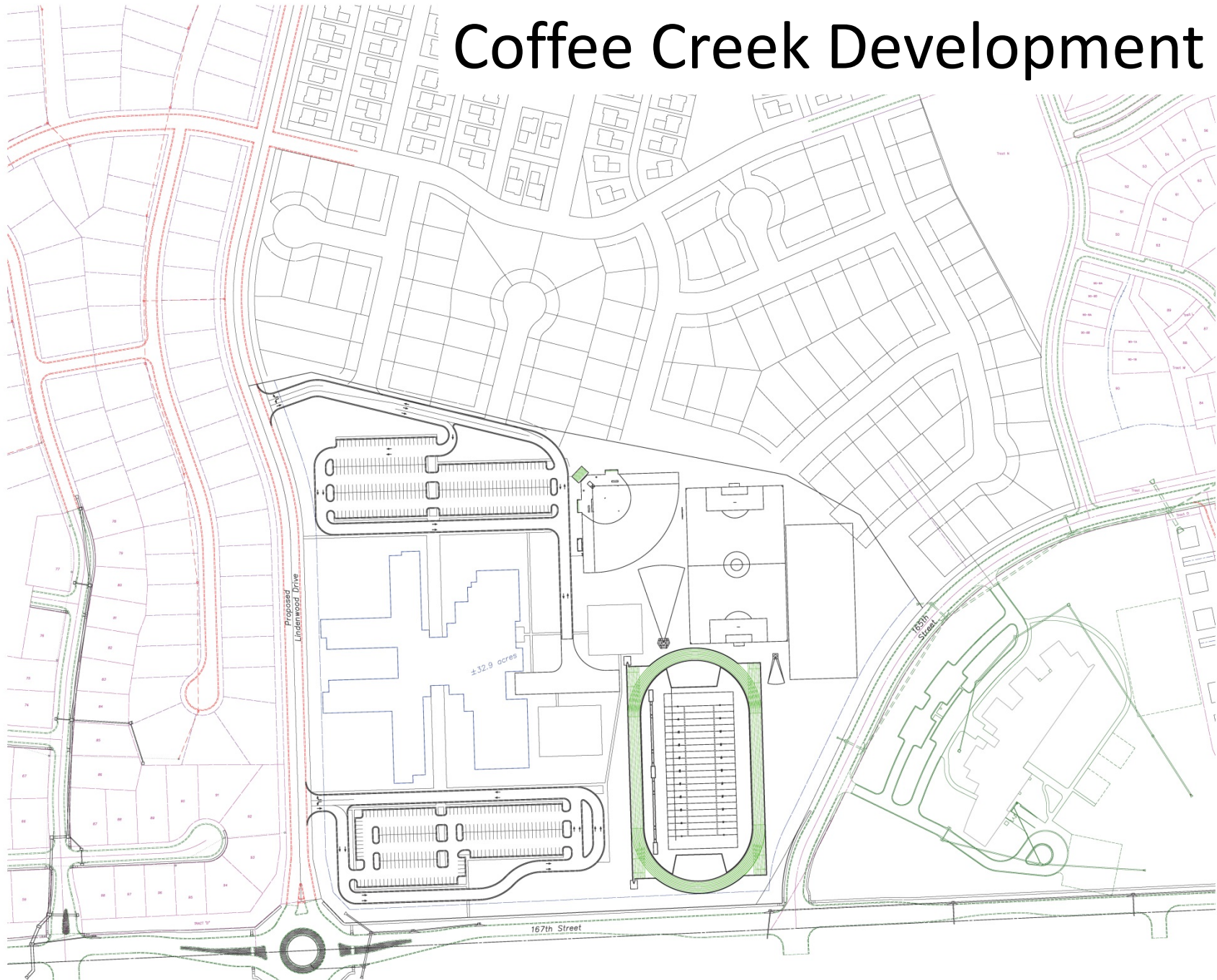

Current District Needs

Current District Needs

- Per the Demographic Report, the District will exceed design capacity at its elementary schools by 2018. Prairie Creek ES will exceed its capacity by 2017. Options:
 - Construct new 528-student ES (per Master Plan)
 - Construct Ph. 1 of new 528-student ES (per Master Plan)
 - Add mobile classrooms and/or increase teacher/student ratio at existing elementary schools
- Per the Demographic Report, the District will exceed design capacity at Spring Hill HS by 2018. Options:
 - Expand SHHS to 1,408-student capacity (per Master Plan)
 - Add mobile classrooms and/or increase teacher/student ratio at existing high school

Current District Needs

- Per the Demographic Report, the District will exceed design capacity at Spring Hill MS (North & South) by 2020. Options:
 - Construct new 528-student MS (per Master Plan)
 - Construct Ph. 1 of new 528-student MS (per Master Plan)
 - Add mobile classrooms and/or increase teacher/student ratio at existing middle school
- Complete District Athletic Complex at Spring Hill HS Campus.
- Expand District Early Childhood Program.
- Address Deferred Maintenance Needs.
 - Parking Lots & Drives (PCES Bus/Car Loops)
 - Roofs
 - Building Infrastructure (HVAC, Plumbing, Electrical)
 - Flooring

Current District Needs

- Address Deferred Technology & Equipment Needs.
 - Personal Computing Devices
 - Technology Infrastructure (wireless, cabling, switches, routers)
 - Furniture
 - Equipment (mowers, tractors)

Future facility solutions to solve student enrollment growth challenges should focus on:

1. New Bldgs. or Additions
2. Increase class size in existing schools
3. Mobile units @ existing schools
4. All of the above

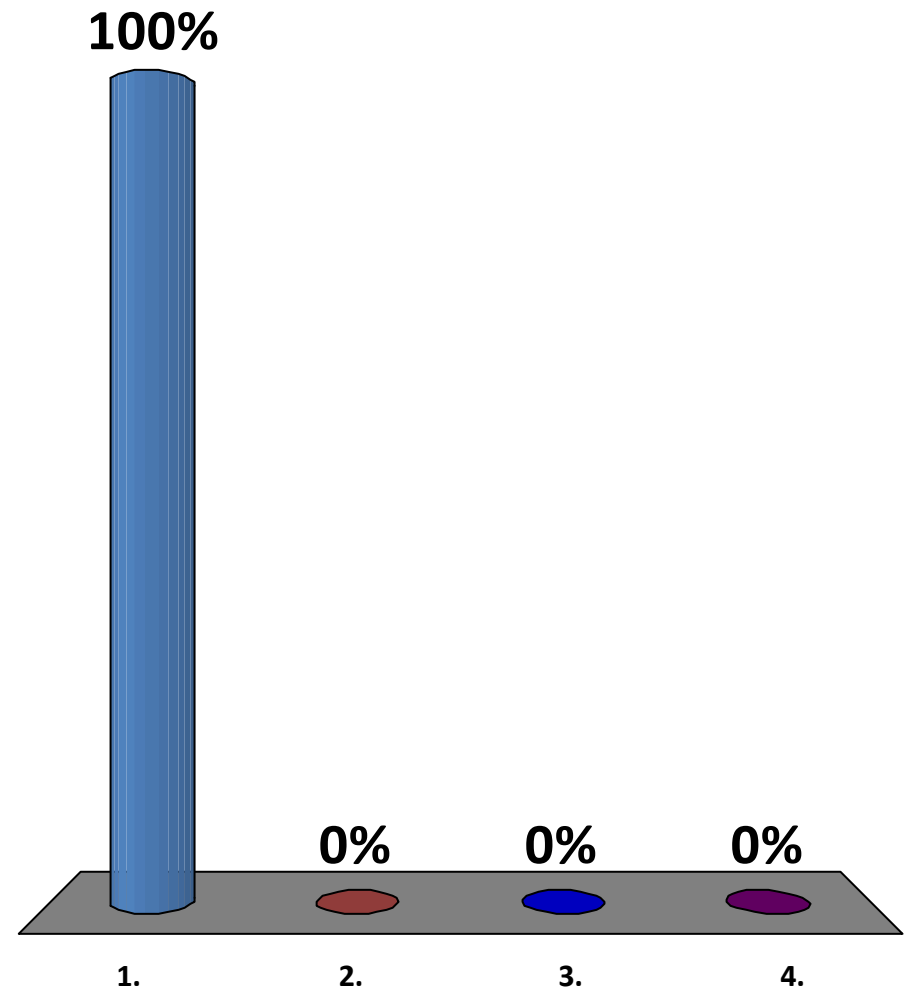

Where does providing schools to accommodate growth rank priority wise compared to other district needs:

1. High
2. Medium
3. Low

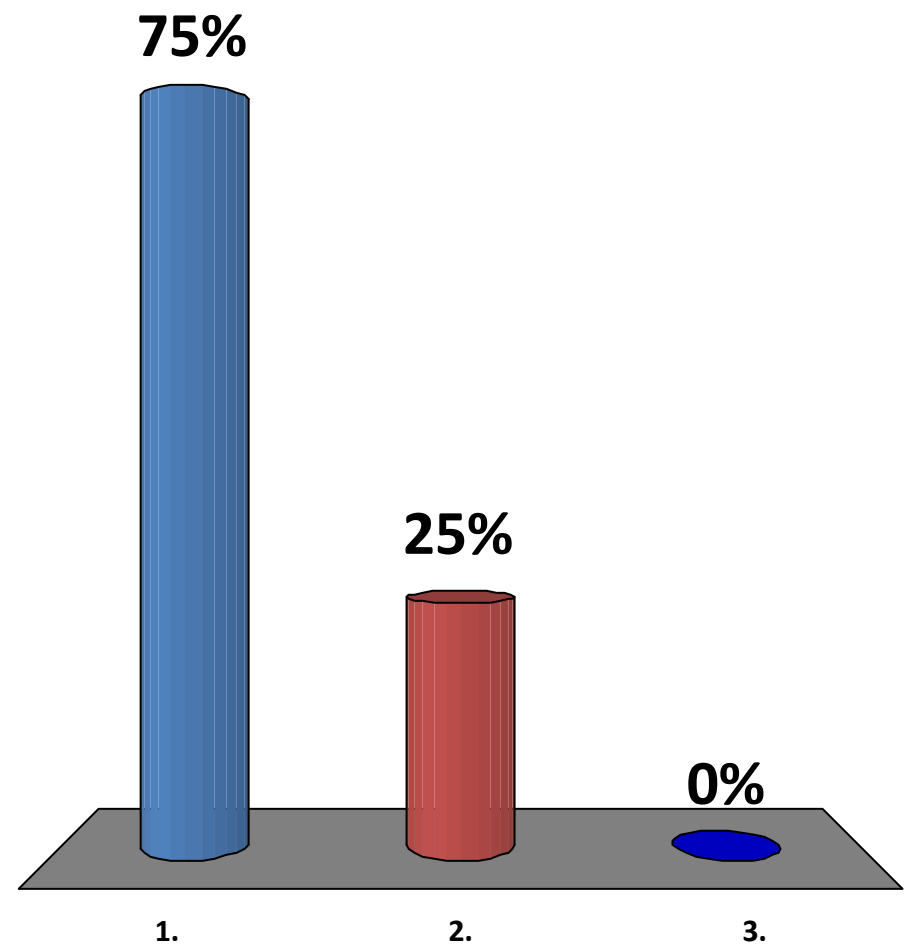

Where does early childhood rank priority wise compared to other district needs:

1. High
2. Medium
3. Low

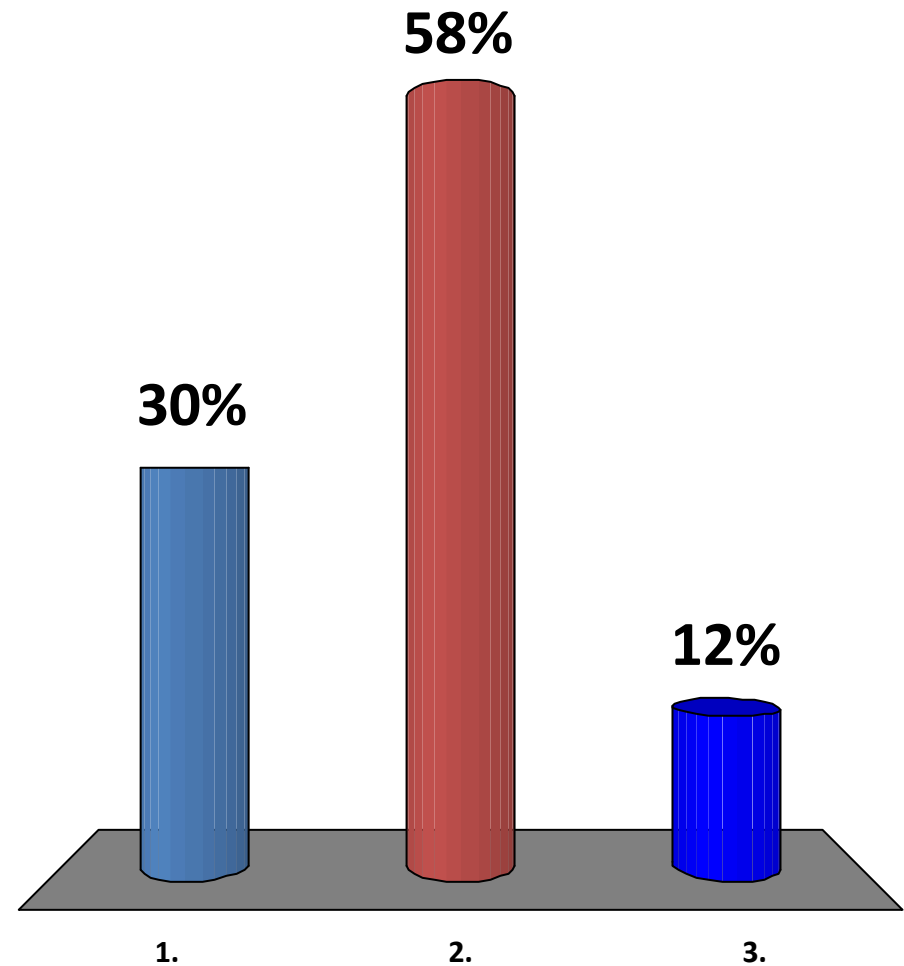

Where does completing the High School District Athletic Complex (DAC) rank priority wise compared to other district needs:

1. High
2. Medium
3. Low

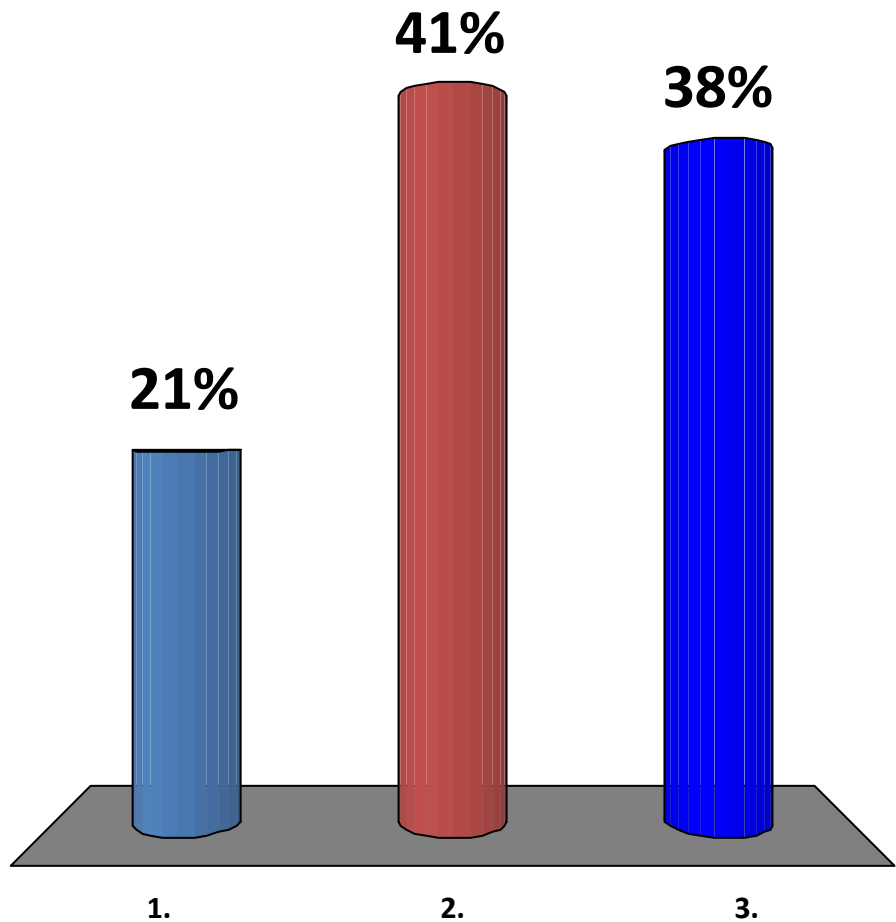

Where does deferred maintenance rank priority wise compared to other district needs:

1. High
2. Medium
3. Low

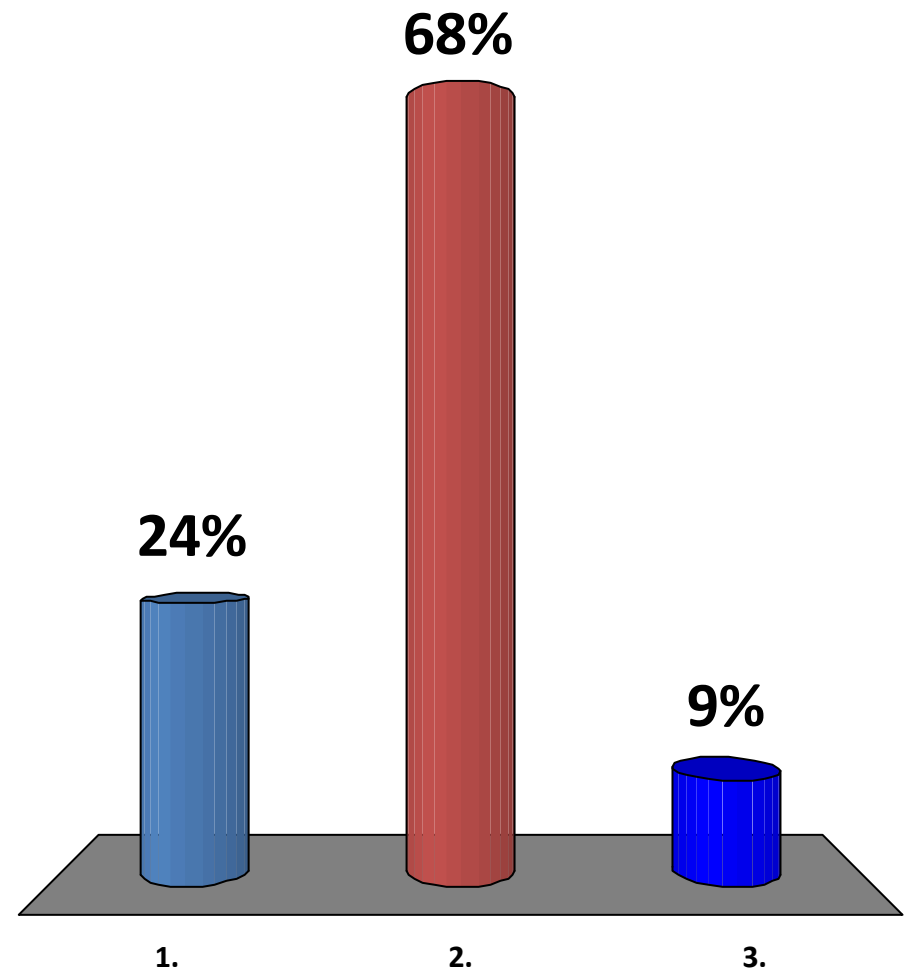

Where does educational technology rank priority wise compared to other district needs:

1. High
2. Medium
3. Low

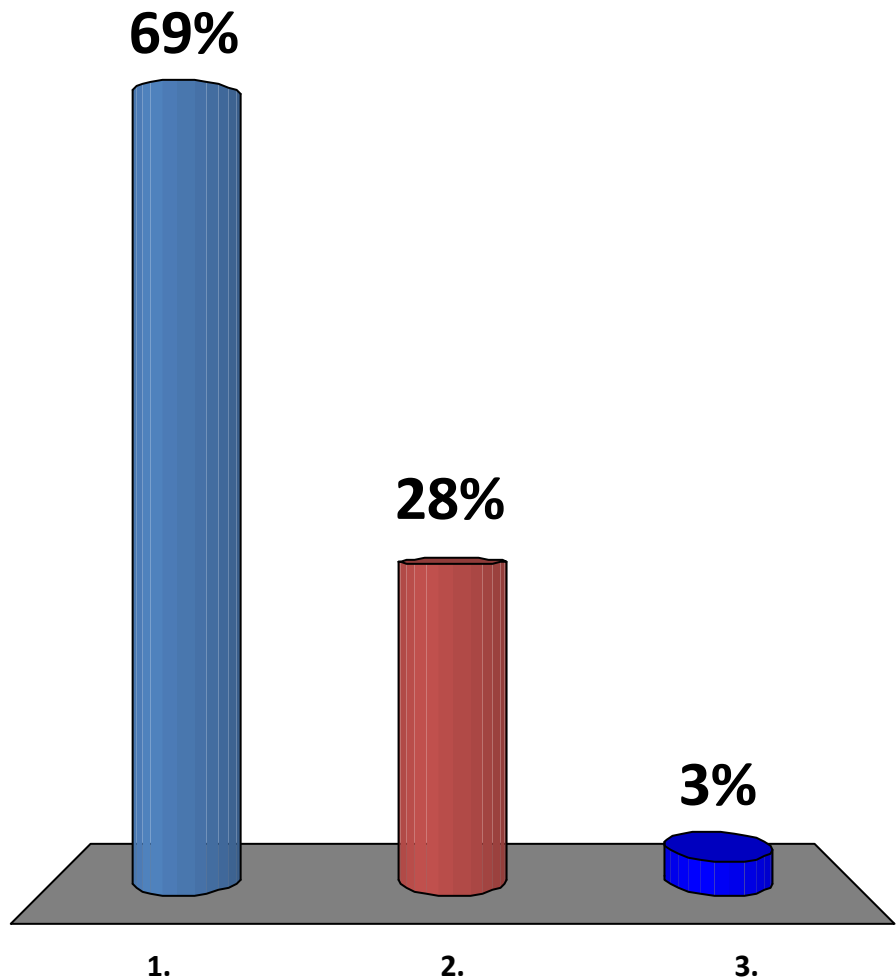

If the District proposed a bond issue today to meet the needs of the students and staff would you:

1. Strongly favor
2. Favor
3. Slightly favor
4. Slightly oppose
5. Oppose
6. Strongly oppose

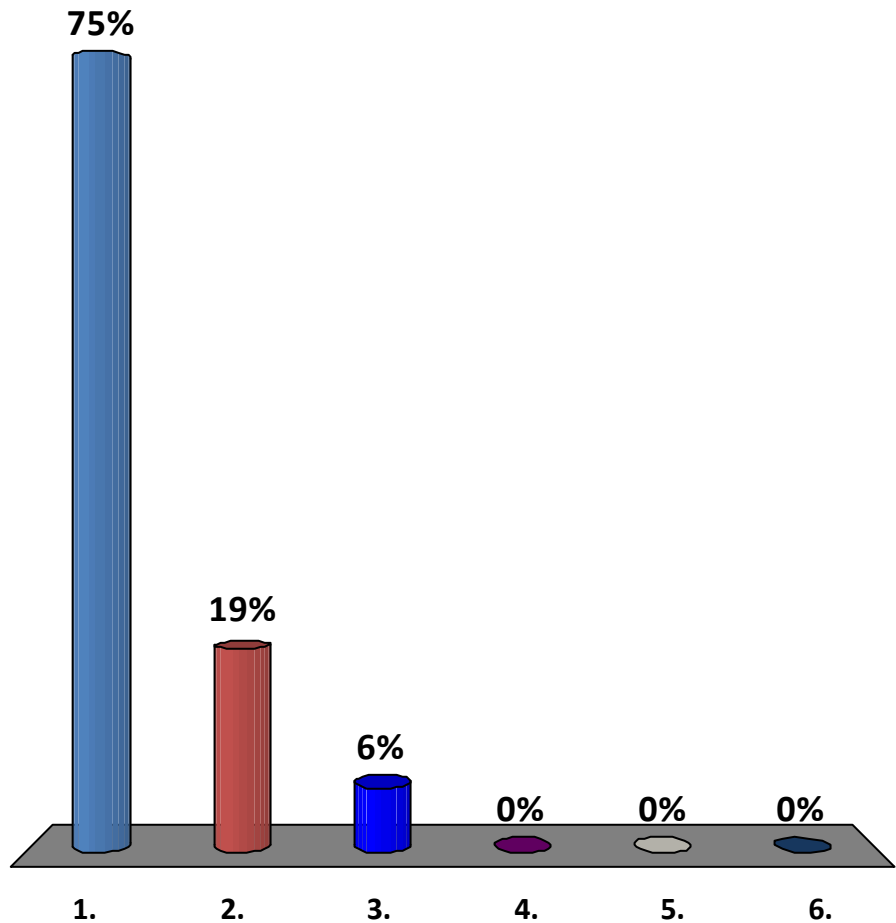

Committee Homework

- **Ask your neighbor/co-worker how they feel about the districts enrollment growth. Are they aware of the challenges it presents.**

We will ask some of you to report out to the committee next week.

Housekeeping

- Next Meeting: Wednesday, April 6, 2016.
Spring Hill High School.

Vision for Growth Committee

Upcoming meetings:

- **Meeting #3 Week of April 4th**
- **Meeting #4 Week of April 18th**
- **Meeting #5 Week of May 2nd**
- **Meeting #6 Week of May 9th**
- **Meeting #7 Week of May 23rd**

**Additional meeting times available
beyond this date if needed.**

Thank You!

